

# Wallpaper guide



The mark of responsible forestry  
All our wallpapers are FSC certified

# Wallpaper guide

- Wallpapering is fast and easy.
- It can make a big change in a short time!
- It is more personal and more fun than painting.

## BEFORE WALLPAPERING

- Check that all rolls feature the same item and batch numbers.
- Inspect the wallpaper to check that it is complete, clean and without any visible defects.
- **Tip!** Wallpapering is easier and quicker if there are two of you to help one another, particularly if you are working high up.

Non-woven wallpapers are very easy to put up, as they are stable, which means that they do not shrink or swell.

You roll the wallpaper paste directly onto the wall and then apply the wallpaper. Apply the paper lengths edge to edge to avoid seams. Below are some simple instructions to guide you step by step through the wallpaper process. In case of complaints, please attach the label from the wallpaper roll. If you have any questions, please contact our customer service at [customerservice@rusta.com](mailto:customerservice@rusta.com)

## PREPARATION

### STEP 1

The first and most important step to successful wallpapering is good preparation. Old surfaces must be washed with sugar soap. The surface to be papered must be solid, smooth, dry, clean and be of uniform colour.

Strongly absorbent surfaces, such as plastered surfaces or surfaces featuring wallcover, must be pre-pasted. When pre-pasting, apply a layer of paste to the wall and allow it to dry thoroughly. Once the paste is completely dry, you can start wallpapering, usually after 24 hours in good ventilation.

Where the surface to be papered features strong contrasts, or where there are significant colour differences between the surface and the new wallpaper, the wall will need priming. Even plastered sections create significant contrasts and require the entire wall to be primed. It is best to prime the wall in a colour close to that of the wallpaper. This is especially important for light and white wallpapers. This ensures any mistakes will be less visible.

We recommend our 'Nyans' wall paint for this.

### STEP 2

Non-woven wallpapers should be pasted directly onto the wall. Apply 'Reflekt Tapetlim Non-woven' directly onto the wall with a roller. Apply paste on a wall surface equal to two lengths of paper at a time.

### STEP 3

**Hanging:** Check the direction of the pattern on the wallpaper. Single colour wallpaper should be hung with the lengths turned for a satisfactory result, i.e. every second length should be hung "upside down".

Wallpaper with elements of silver or gold may become dust traps. Therefore, take extra care when using these.

You do not have to cut the wallpaper lengths in advance. Apply the length towards the ceiling + about 5 cm extra for cutting off, then roll out the wallpaper as far as it is needed. Check that the first length is vertical particularly carefully using a plumb or laser. If it is not vertical, remove it from the wall completely. The wallpaper cannot be adjusted sideways on the wall, as it may slide back once the paste is dry.

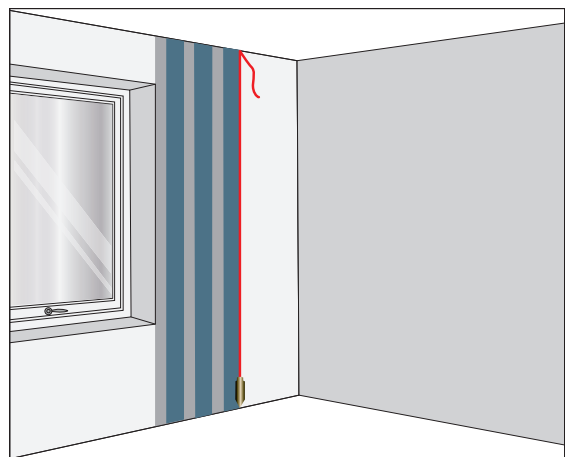

Check the first length particularly carefully with a plumb.

## STEP 4

Use a wallpaper smoother to attach the wallpaper and squeeze out any air bubbles. Start in the middle and press out towards the edges. Be careful not to be too rough or you may damage the wallpaper. Cut the wallpaper length with a wallpaper knife. Tip! Replace the blade on the wallpaper knife frequently during wallpapering. A sharp blades gives straighter lines.

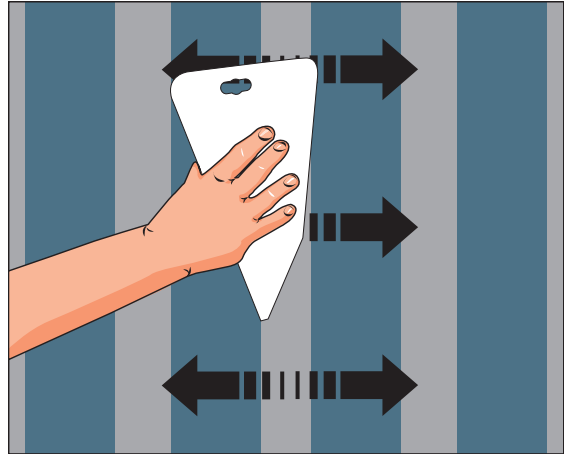

Use a wallpaper smoother to attach the wallpaper and squeeze out any air bubbles.

## STEP 5

Non-woven wallpapers should be hung edge to edge. The lengths must not overlap. Press the seams together and remove any excess paste using a **wallpaper sponge** and lukewarm water.

Any paste spilled on the front of the wallpaper must be carefully removed immediately using a soft, clean, damp Reflekt **wallpaper sponge**. Rags or the like must not be used. Do not rub the wallpaper – the wallpaper may lose colour when wet. This applies in particular to wallpapers featuring strong colours. The wallpaper can be wiped once it is dry.

## STEP 6

Make sure there is good ventilation during the drying time. Do not close the door. Expect a drying time of at least 24 hours.

For more information, visit our website  
[www.rusta.com](http://www.rusta.com)



Any paste spilled on the front of the wallpaper must be carefully removed immediately using a soft, damp wallpaper sponge.

## WALLPAPERING IN INNER CORNERS

When wallpapering corners, the length must pass over the corner so that the seam looks nice on the wall.

### STEP 1

Pull up the wallpaper length as usual and adjust the wallpaper so the pattern matches the previous length. Cut the length to the right length. Then measure from the edge of the length already on the wall and into the corner. Add about 10 mm and mark the width on the length with a pencil. Then cut the length to the right width using a ruler. For example, Rusta's 1.5 metre ruler.

### STEP 2

Paste the wall.

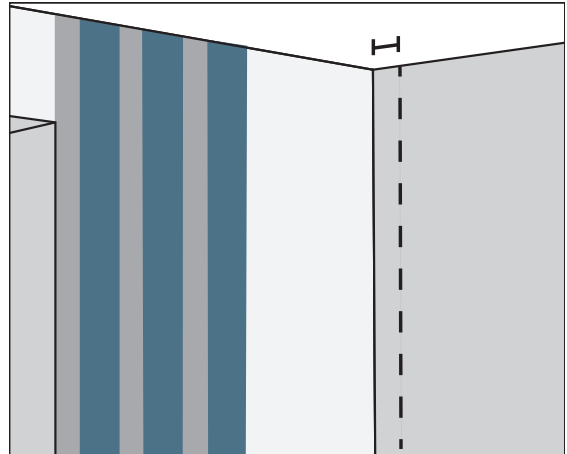

Measure from the edge of the length already on the wall and into the corner. Add about 10 mm and mark the width on the length with a pencil.

### STEP 3

Attach the cut length edge-to-edge with the previous length. The cut length must go over the corner. Then smooth out any air bubbles using the wallpaper smoother.

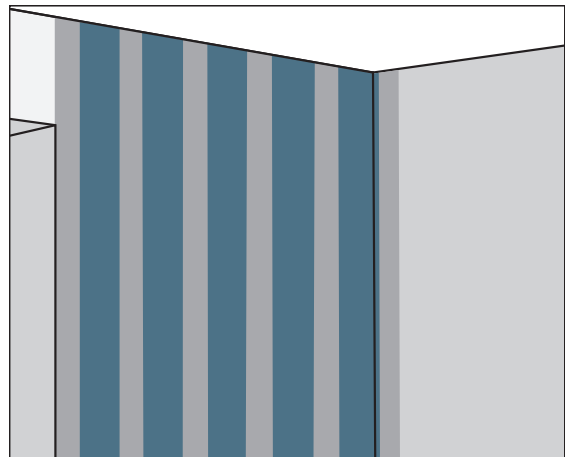

Attach the cut length edge-to-edge with the previous length. The cut length must go over the corner.

### STEP 4

For the next length, use the trimmed section of the length from step 1. Paste the wall into the corner where the next length will be hung. Attach the length. Use a laser or plumb in the corner to get a straight line. Then continue wallpapering as usual.

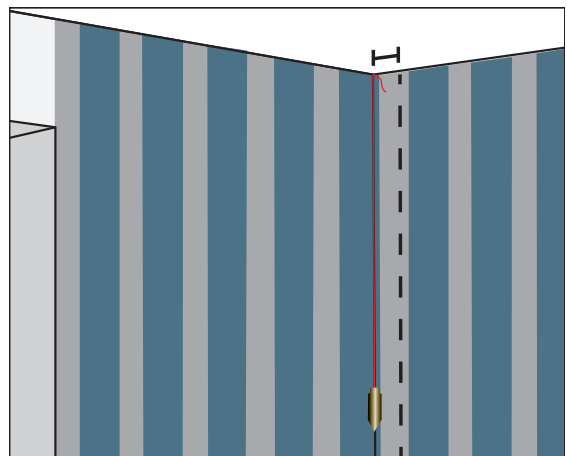

The next length will overlap the cut length. The length will go into the corner.

## WALLPAPERING AROUND WINDOWS AND DOORS

### STEP 1

Paste the wall.

### STEP 2

Pull up the wallpaper length as usual and adjust the wallpaper so the pattern matches the previous length. Then press along the length right up to the top towards the ceiling.

### STEP 3

Mark with your finger where the top corner is on the door/window. Then lift up the part of the length hanging over the window/door. From the corner of the window/door, you then make a cut in the wallpaper – from the top and diagonally in towards the centre of the window/door. Cut the wallpaper all the way out to the edges.



Mark with your finger where the top corner is on the door/window. Then lift up the part of the length hanging over the window/door. From the corner of the window/door, you then make a cut in the wallpaper – from the top and diagonally in towards the centre of the window/door. Cut the wallpaper all the way out to the edges.

### STEP 4

After that it is easy to press down the wallpaper using a wallpaper smoother towards the edge of the window/door so that you can then cut off any excess paper.

### STEP 5

Repeat steps 1-4 around the trims.



After that it is easy to press down the wallpaper using a wallpaper smoother towards the edge of the window/door so that you can then cut off any excess paper.

**WALLPAPERING AROUND AN ELECTRICAL SOCKET**

**Make sure to turn off the power supply to the electrical socket before starting work!**

**STEP 1**

Remove the box located over the power socket.

**STEP 2**

Paste the wall and wallpaper over the socket.

**STEP 3**

Cut a cross in the wallpaper where the socket will be located.

**STEP 4**

Then make a hole in the wallpaper that is smaller than the box.

**STEP 5**

Replace the box.

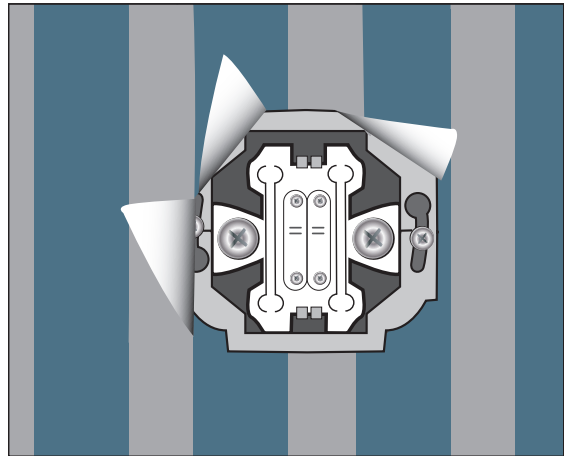

Cut a cross in the wallpaper where the socket will be located.

**WE WISH YOU LUCK WITH YOUR WALLPAPERING!**



Customer Service Rusta

Consumer contact:

Website:

E-mail:

Rusta Customer Service, Box 5064, 194 05 Upplands Väsby, SWEDEN

[www.rusta.com](http://www.rusta.com)

[customerservice@rusta.com](mailto:customerservice@rusta.com)